

INSPECTION

1. INSPECT FRONT PERSONAL LIGHT SWITCH CONTINUITY

Switch position	Tester connection	Specified condition
Interior light switch OFF (Lever switch)	–	No continuity
Interior light switch DOOR (Lever switch)	1 – 3	Continuity
Interior light switch ON (Lever switch)	1 – 2	Continuity
*Personal light OFF (Push switch)	–	No continuity
*Personal light ON (Push switch)	1 – 2	Continuity

*: Set the interior light switch to OFF or DOOR.

If continuity is not as specified, replace the light assembly or bulb.

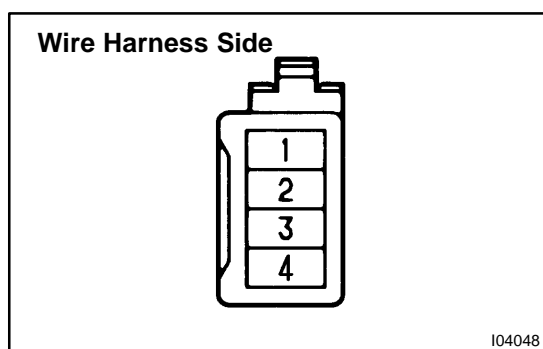

2. INSPECT FRONT PERSONAL LIGHT SWITCH CIRCUIT

(See page [DI-996](#))

Disconnect the connector from the switch and inspect the connector on the wire harness side, as shown.

Tester connection	Condition	Specified condition
2 – Ground	Constant	Continuity
1 – Ground	Constant	Battery positive voltage

If circuit is not as specified, inspect power source or wire harness.

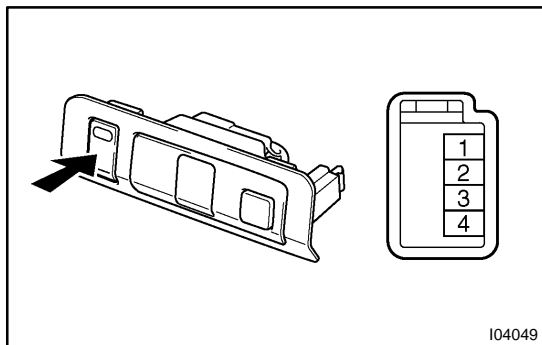

3. INSPECT REAR PERSONAL LIGHT SWITCH CONTINUITY

Switch position	Tester connection	Specified condition
Room light switch OFF and door closed	–	No continuity
Room light switch ON and door closed	1 – 2	Continuity
Room light switch OFF or ON and door opened	1 – 3	Continuity

If continuity is not as specified, replace the light assembly or bulb.

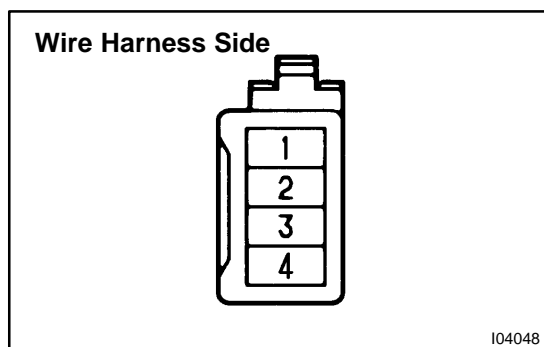

4. INSPECT REAR PERSONAL LIGHT SWITCH CIRCUIT

Disconnect the connector from the switch and inspect the connector on the wire harness side, as shown.

Tester connection	Condition	Specified condition
2 – Ground	Constant	Continuity
1 – Ground	Constant	Battery positive voltage

If circuit is not as specified, inspect power source or wire harness.

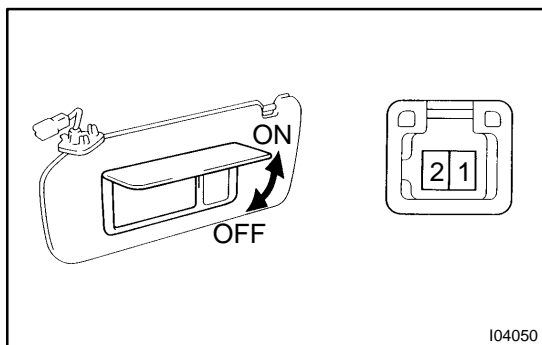

5. INSPECT VANITY LIGHT CONTINUITY

Switch position	Tester connection	Specified condition
OFF (closed)	–	No continuity
ON (opened)	1 – 2	Continuity

If continuity is not as specified, replace the vanity light assembly or bulb.

Wire Harness Side

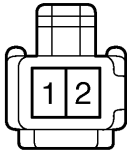

I04051

6. INSPECT VANITY LIGHT CIRCUIT

Disconnect the connector from the light and inspect the connector on the wire harness side, as shown.

Tester connection	Condition	Specified condition
2 – Ground	Constant	Continuity
1 – Ground	Constant	Battery positive voltage

If circuit is not as specified, inspect power source or wire harness.

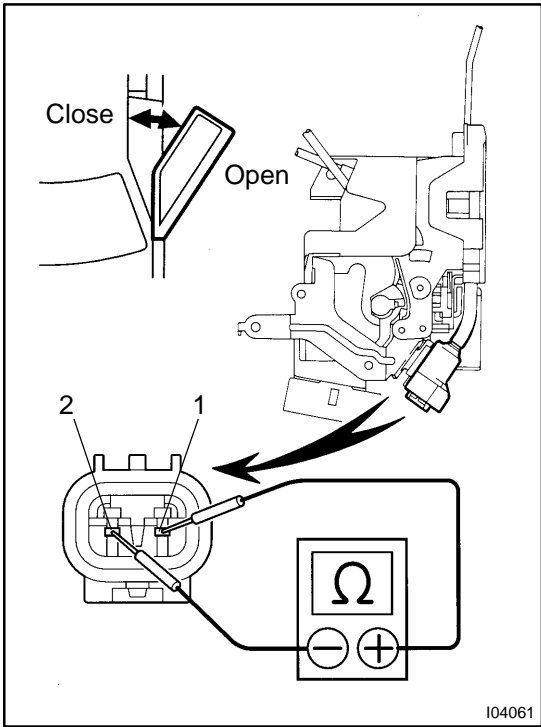

I04061

7. Front door:

INSPECT DOOR COURTESY SWITCH CONTINUITY

- Connect the connector to the front door ECU.
- Check that continuity exists between terminals 1 and 2 when door is opened.
- Check that no continuity exists between terminals 1 and 2 when door is closed.

If continuity is not as specified, replace the switch.

8. Front door:

INSPECT DOOR COURTESY SWITCH CIRCUIT

Driver side: (See page [DI-1019](#))

Passenger side: (See page [DI-1053](#))

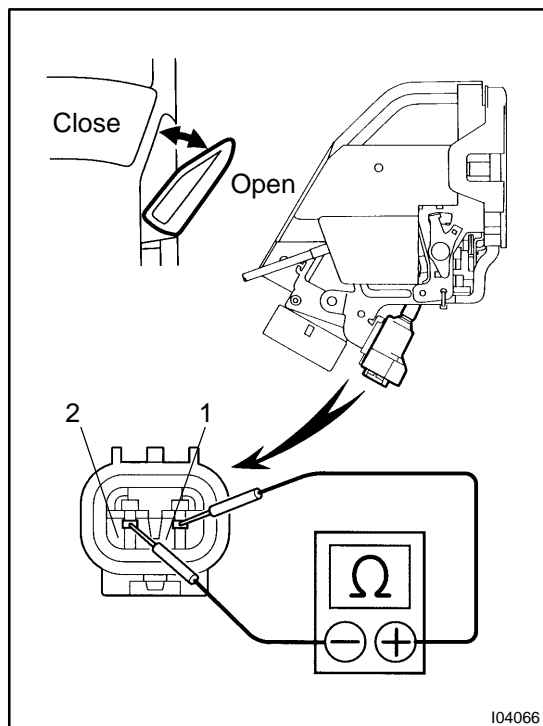
**9. Rear door:****INSPECT DOOR COURTESY SWITCH CONTINUITY**

- (a) Connect the connector to the rear door ECU.
- (b) Check that continuity exists between terminals 1 and 2 when door is opened.
- (c) Check that no continuity exists between terminals 1 and 2 when door is closed.

If continuity is not as specified, replace the switch.

10. Rear door:**INSPECT DOOR COURTESY SWITCH CIRCUIT**

Rear LH side: (See page [DI-1085](#))

Rear RH side: (See page [DI-1102](#))

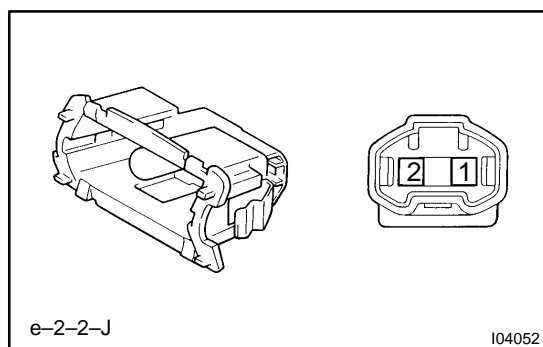
**11. INSPECT DOOR COURTESY LIGHT CONTINUITY**

Using an ohmmeter, check that continuity exists between terminals.

If continuity is not as specified, replace the light assembly or bulb.

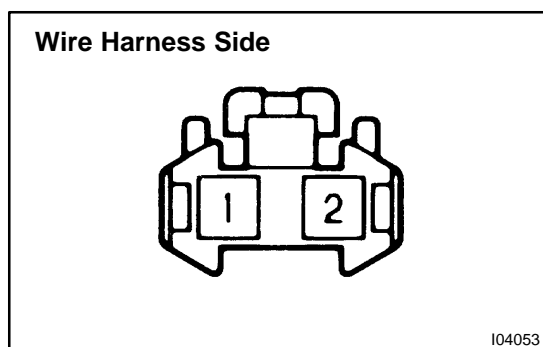
**12. INSPECT DOOR COURTESY LIGHT CIRCUIT**

Driver side: (See page [DI-1025](#))

Passenger side: (See page [DI-1059](#))

Rear LH side: (See page [DI-1089](#))

Rear RH side: (See page [DI-1106](#))

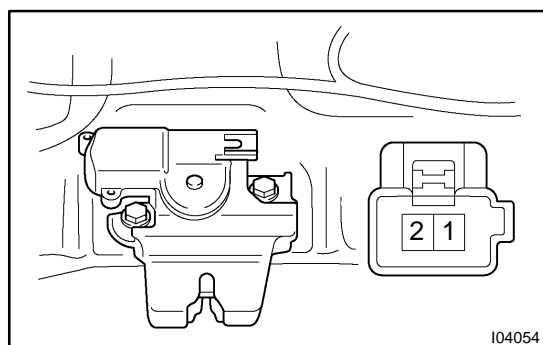
**13. INSPECT LUGGAGE COMPARTMENT DOOR COURTESY SWITCH CONTINUITY**

Switch position	Tester connection	Specified condition
OFF (closed)	–	No continuity
ON (opened)	2 – Switch body	Continuity

If continuity is not as specified, replace the switch.

Wire Harness Side

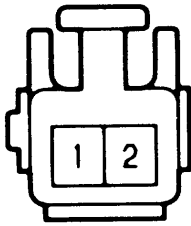

I04185

14. INSPECT LUGGAGE COMPARTMENT DOOR COURTESY SWITCH CIRCUIT

(See page [DI-943](#))

Disconnect the connector from the switch and inspect the connector on the wire harness side, as shown.

Tester connection	Condition	Specified condition
2 – Body ground	Luggage compartment door courtesy switch ON (door opened)	Continuity

If circuit is not as specified, inspect power source or wire harness.

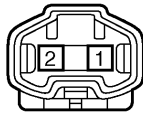
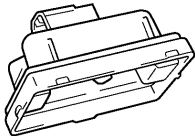

e-2-2-J

I04056

15. INSPECT LUGGAGE COMPARTMENT LIGHT CONTINUITY

Using an ohmmeter, check that continuity exists between terminals.

If continuity is not as specified, replace the light assembly or bulb.

Wire Harness Side

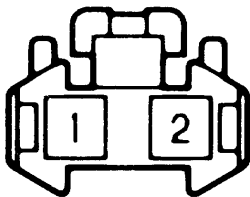

I04053

16. INSPECT LUGGAGE COMPARTMENT LIGHT CIRCUIT

Disconnect the connector from the light and inspect the connector on the wire harness side, as shown.

Tester connection	Condition	Specified condition
1 – Body ground	Constant	Continuity

If circuit is not as specified, inspect power source or wire harness.

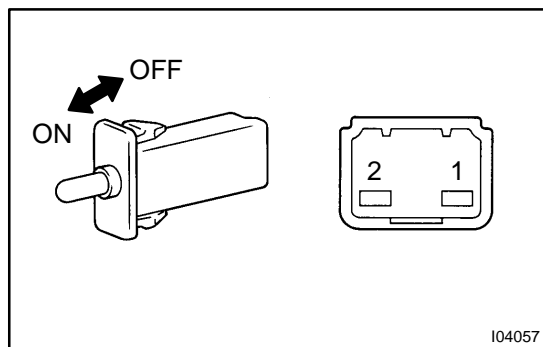

17. INSPECT GLOVE COMPARTMENT DOOR COURTESY SWITCH CONTINUITY

Switch position	Tester connection	Specified condition
OFF (closed)	–	No continuity
ON (opened)	1 – 2	Continuity

If continuity is not as specified, replace the switch.

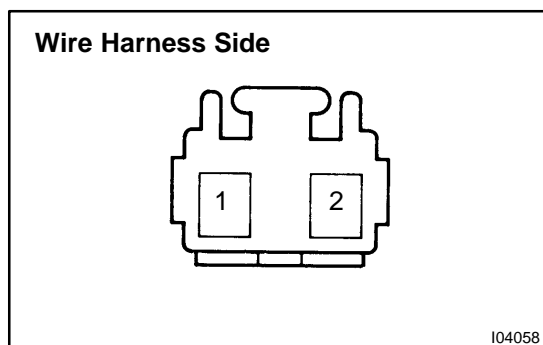

18. INSPECT GLOVE COMPARTMENT DOOR COURTESY SWITCH CIRCUIT

Disconnect the connector from the switch and inspect the connector on the wire harness side, as shown.

Tester connection	Condition	Specified condition
2 – Ground	Constant	Continuity
1 – Ground	Light control switch OFF	No voltage
1 – Ground	Light control switch TAIL or HEAD	Battery positive voltage

If circuit is not as specified, inspect power source or wire harness.

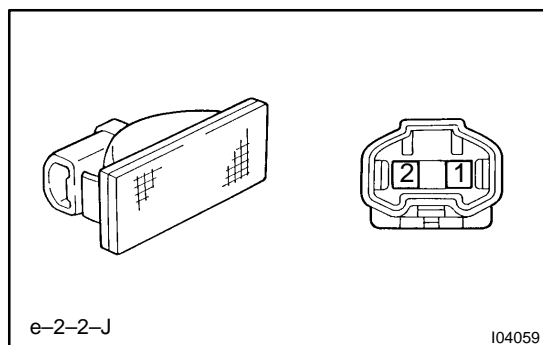

19. INSPECT GLOVE COMPARTMENT LIGHT CONTINUITY

Using an ohmmeter, check that continuity exists between terminals.

If continuity is not as specified, replace the light assembly or bulb.

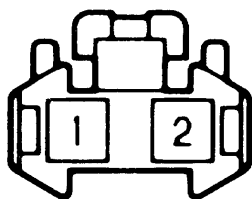
Wire Harness Side

I04053

20. INSPECT GLOVE COMPARTMENT LIGHT CIRCUIT

Disconnect the connector from the light and inspect the connector on the wire harness side, as shown.

Tester connection	Condition	Specified condition
2 – Ground	Glove compartment door courtesy switch ON	Continuity
1 – Ground	Light control switch in TAIL or HEAD	Battery positive voltage

If circuit is not as specified, inspect power source or wire harness.

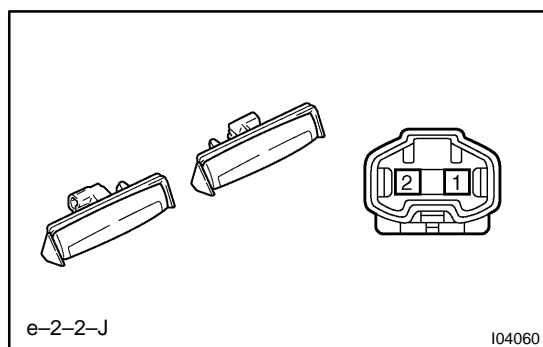

e-2-2-J

I04060

21. INSPECT LICENCE PLATE LIGHT CONTINUITY

Using an ohmmeter, check that continuity exists between terminals.

If continuity is not as specified, replace the light assembly or bulb.

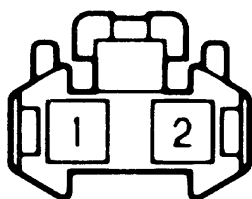
Wire Harness Side

I04053

22. INSPECT LICENCE PLATE LIGHT CIRCUIT

Disconnect the connector from the light and inspect the connector on the wire harness side, as shown.

Tester connection	Condition	Specified condition
1 – Ground	Constant	Continuity
2 – Ground	Light control switch TAIL or HEAD	Battery positive voltage

If circuit is not as specified, inspect power source or wire harness.